

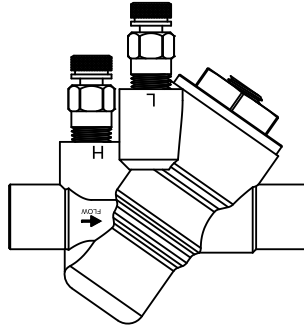

AFLM Series Specifications
Automatic Pressure Independent Flow Limiter Micro



U.S. Patent No. 8,061,195

PRODUCT DESCRIPTION: The AFLM is a Automatic Pressure Independent Flow Limiting Device. The AFLM is supplied with a stainless steel flow limiting cartridge it can be removed for cleaning or cartridge exchange, if necessary. The AFLM comes in SWT by SWT end connections, upstream and downstream 1/4" ports and 1/4" port in the removable cap.

STANDARD MATERIAL SPECIFICATIONS		STANDARD OPERATING SPECIFICATIONS	
Body	Forged Brass ASTM B283-06	Control range:	2 psi - 60+ psi
O-Ring	EPDM	Accuracy:	±5%
Flow Cartridge	ASTM A582 Type 303 Stainless Steel	Max Working Pressure:	600 WOG / CWP
Diaphragm	EPDM	Max Operating Temperature:	250°F
Spring	302 Stainless Steel	Start-Up Head Loss:	5 Feet of H ₂ O
PT Port	EPDM Dual Durometer Core	Specification information is provided to assist and is given without obligation or warranty. The Company reserves the right to make changes in design, materials, and/or specifications without notice or liability.	

Valve Size	FLOW RATES (GPM)* CONTROL RANGE 2 - 60+ PSID																									
	A	B	C	D	E	F	G	H	I	J	K	L	M	N	O	P	Q	R	S	T	U	V	W	X	Y	Z
1/2" - 3/4"	.33	.50	.75	1	1.25	1.5	1.75	2	2.25	2.5	2.75	3	3.5	4	4.5	5	5.5	6	6.5	7	7.5	8	9	10	11	12

* Custom flow rates can be calibrated at the factory for an additional charge.
Unless confirmed as special, flow rates will default to standard flow rate.

PRODUCT SPECIFICATIONS:

- AFLM shall have flow measurement capability
- The AFLM shall have a static orifice to control flow when equipped with flow limiting cartridge
- The AFLM Cartridge shall be permanently marked with the letter that corresponds to the factory preset GPM
- All flow cartridge wear surfaces shall be stainless steel
- The AFLM shall have a 2 PSID start up rating
- The AFLM Cartridge shall have a large operational differential range
- The AFLM Cartridge shall provide continual flow at differential pressures at the above design limits
- The AFLM Cartridge shall be removable for cleaning or exchange if required



AFLM Series Specifications
Automatic Pressure Independent Flow Limiter Micro

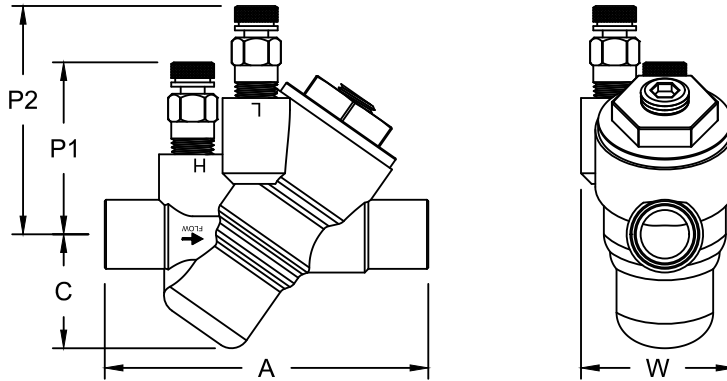

SIZE	A	C	P1	P2	W	WEIGHT (lbs)
1/2" SWT x 1/2" SWT	3.5	1.2	2.1	2.7	1.7	1.0
3/4" SWT x 3/4" SWT	3.8	1.3	2.2	2.7	1.7	1.1

Note: Dimensions listed above do not include ProPress or any other special fittings or adapters. All dimensions, weights, and materials are subject to minor variations. Consult with factory for confirmation of dimensions and material specifications. Sweat size listed is nominal and will differ from the actual, measurable size.



AFLM Series Specifications
Automatic Pressure Independent Flow Limiter Micro

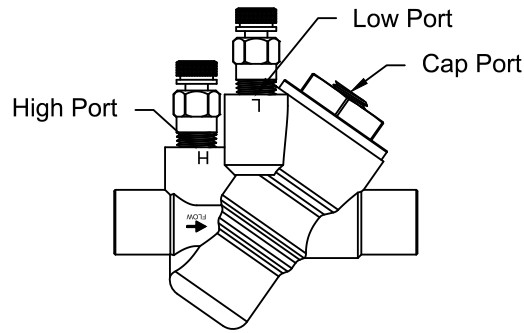

U.S. Patent No. 8,061,195

AFLM - X - X - XX - XX - XX

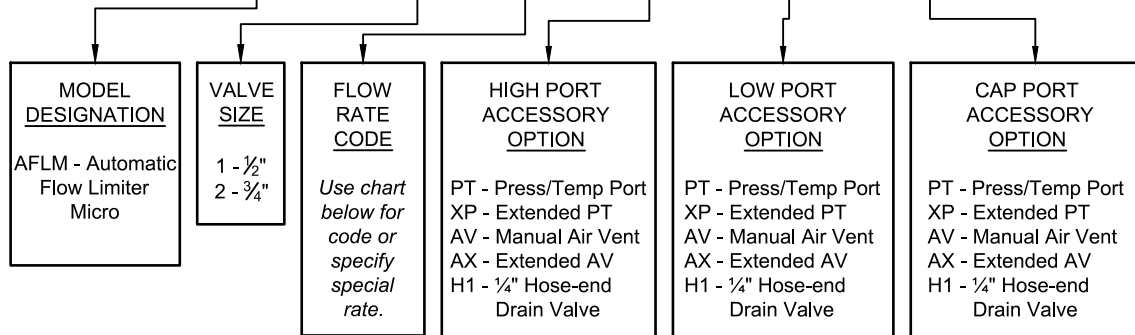

Valve Size	FLOW RATE CODES (GPM)* CONTROL RANGE 2 - 60+ PSID **																									
	A	B	C	D	E	F	G	H	I	J	K	L	M	N	O	P	Q	R	S	T	U	V	W	X	Y	Z
A 1/2" - 3/4"	.33	.50	.75	1	1.25	1.5	1.75	2	2.25	2.5	2.75	3	3.5	4	4.5	5	5.5	6	6.5	7	7.5	8	9	10	11	12

* Custom flow rates can be calibrated at the factory for an additional charge.
 Unless confirmed as special, flow rates will default to standard flow rate.

JOB NAME:		REPRESENTATIVE:	
ENGINEER:		REF/PO#:	
CONTRACTOR:		SUBMITTED BY:	
DATE:		DATE:	
PART # (See table above)	TAGGING/JOB INFORMATION	GPM	QUANTITY