

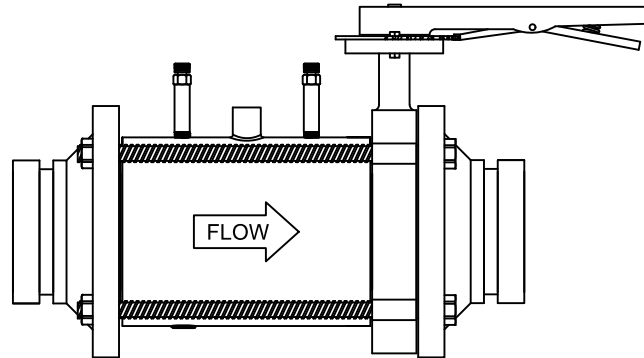

AFLWG Series Specifications

Automatic Pressure Independent Flow Limiter Wafer w/ Groove End



U.S. Patent No. 8,061,195

PRODUCT DESCRIPTION: The AFLWG is a combination butterfly valve, wafer style automatic flow limiting device, and an ANSI Class 150# grooved end flange's. The full flange face wafer contains one or more stainless steel flow limiting cartridges that are preset at the factory for a specific flow. The cartridges can be removed for cleaning, and if necessary, cartridge exchange. The Nodular cast iron butterfly valve has a combination infinite/10 position memory stop plate, a one piece disc/shaft, a triple shaft bearing, an stainless steel disc, and an EPDM liner. AFLWF comes with (2) EXT PT's, Flange gasket and rod set.

STANDARD MATERIAL SPECIFICATIONS		
	Wafer	ASTM A536 Ductile Iron
	O-Ring	EPDM
	Flow Cartridge	ASTM A582 Type 303 Stainless Steel
	Diaphragm	EPDM
	Spring	Stainless Steel
	PT Port	EPDM Dual Durometer Core
	Flange Gasket	Aramid Fiber/NBR
	Flange	Forged Carbon Steel ASTM A105
	Bolts	ASTM A193 Steel
Butterfly Valve *	Body	Nodular Cast Iron
	Seat	EPDM
	Disc	Stainless Steel
	Stem	Stainless Steel
	Seal Support	Plastic
	O-Ring	NBR
	Bushings	PTFE
	Taper Pin	Stainless Steel
* Butterfly valve is rated at 200 PSIG and is suitable for dead-end service		
PRODUCT SPECIFICATIONS		
	Cartridge Control range:	2 psi - 60+ psi
	Accuracy:	±5%
	Start-Up Head Loss:	5 Feet of H ₂ O
Specification information is provided to assist and is given without obligation or warranty. The Company reserves the right to make changes in design, materials, and/or specifications without notice or liability.		

NOTE: The specific ASTM standard may vary and should be confirmed at time of order.



AFLWG Series Dimensions

Automatic Pressure Independent Flow Limiter Wafer w/ Groove End

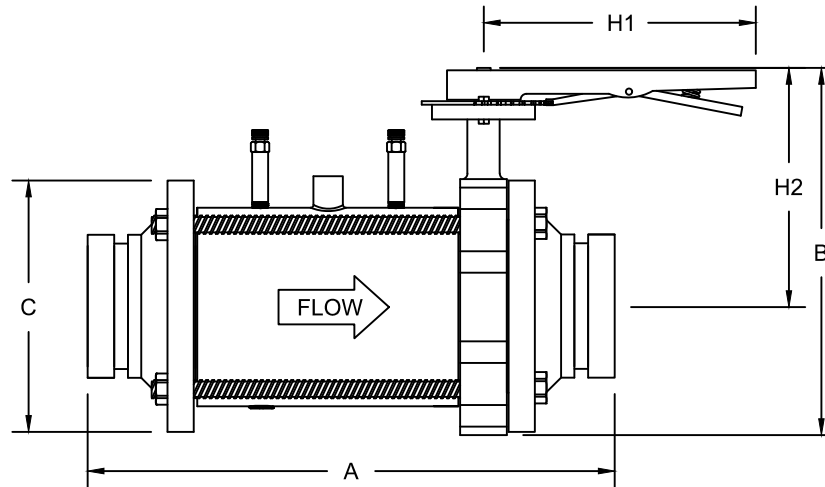

U.S. Patent No. 8,061,195

SIZE	MODEL	A	B	C	H1	H2	WEIGHT	No. of AFL Cartridges	Max GPM FLOW
2½"	AFLWG250	15.31	11.65	7.00	10.25	8.15	48	1	70
3"	AFLWG300	15.31	12.13	7.50	10.25	8.39	57	1	130
4"	AFLWG400	17.05	14.80	9.00	10.25	9.13	81	2	270
5"	AFLWG500	18.20	14.65	10.00	10.25	9.65	102	3	410
6"	AFLWG600	18.20	15.63	11.00	10.25	10.16	125	4	560
8"	AFLWG800	19.36	18.90	13.50	*	20.67	197	7	960
10"	AFLWG1000	22.68	21.26	16.00	*	13.27	300	12	1600

* Denotes a gear operated valve.

Note: All dimensions are in inches and all weights are in pounds. All dimensions, weights, and materials are subject to minor variations. Consult with factory for confirmation of dimensions, weights, and material specifications at the time of order.