

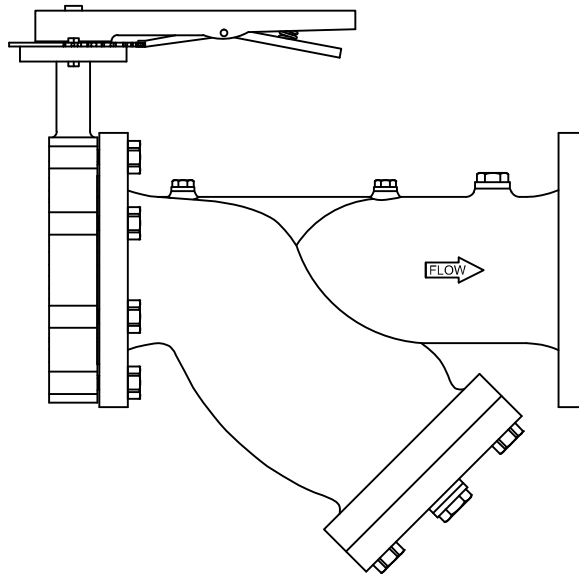

## CBYS Series Specifications

### Combination Butterfly Valve & Wye Strainer



**PRODUCT DESCRIPTION:** The CBYS is a combination butterfly valve and flange x flange end wye strainer. The cast iron wye strainer has standard ANSI Class 125 pound flange ends that connect to a lug type butterfly valve for throttling/isolation. The cast iron butterfly valve has a one piece disc/shaft, a triple shaft bearing, an aluminum-bronze disc for sizes 2½" - 8", a nickel plated disc for the 10" and 12" sizes, and an EPDM liner. The strainer comes with a stainless steel perforated filter element, a (2) ¼" plugs, (1) ½" plug, (1) ¾" blow-off connection, and a flanged blow-off cover with an EPDM o-ring. Accessories are available for an additional charge.

STANDARD MATERIAL SPECIFICATIONS			
WYE STRAINER		BUTTERFLY VALVE	
Body	Gray Iron Casting ASTM A126 Class B	Body	Nodular Cast Iron ASTM A536 60-4-18
Cap	Gray Iron Casting ASTM A126 Class B	Seat	EPDM Rubber
Filter (Screen)	Stainless Steel A276	Disc (2½ - 8")	Aluminum-Bronze Sand Casting, ASTM B148 C95400
O-Rings	EPDM Rubber	Disc (10 & 12")	Nickel Plated Aluminum-Bronze Sand Casting, ASTM B148 C95800
¼" Plug	Ductile Iron Casting ASTM A536 60-40-18	Shaft	Stainless Steel AISI 410
½" Plug	Ductile Iron Casting ASTM A536 60-40-18	O-Ring	EPDM Rubber
¾" Plug	Ductile Iron Casting ASTM A536 60-40-18	Bearing	Copper ASTM B45
Bolt	Carbon Steel ASTM A307	Bearing Bush	PTFE
Nut	Carbon Steel ASTM A307	Hand Lever	Nodular Cast Iron ASTM A536 60-4-18
<p>Specification information is provided to assist and is given without obligation or warranty. The Company reserves the right to make changes in design, materials, and/or specifications without notice or liability.</p>			

**PRODUCT SPECIFICATIONS:**

- Butterfly valve is rated at 150 PSIG and is suitable for dead-end service
- Stainless steel screen aids in filtering dirt, rust, and debris in the piping system and may be removed for cleaning



## CBYS Series Dimensions Combination Butterfly Valve & Wye Strainer

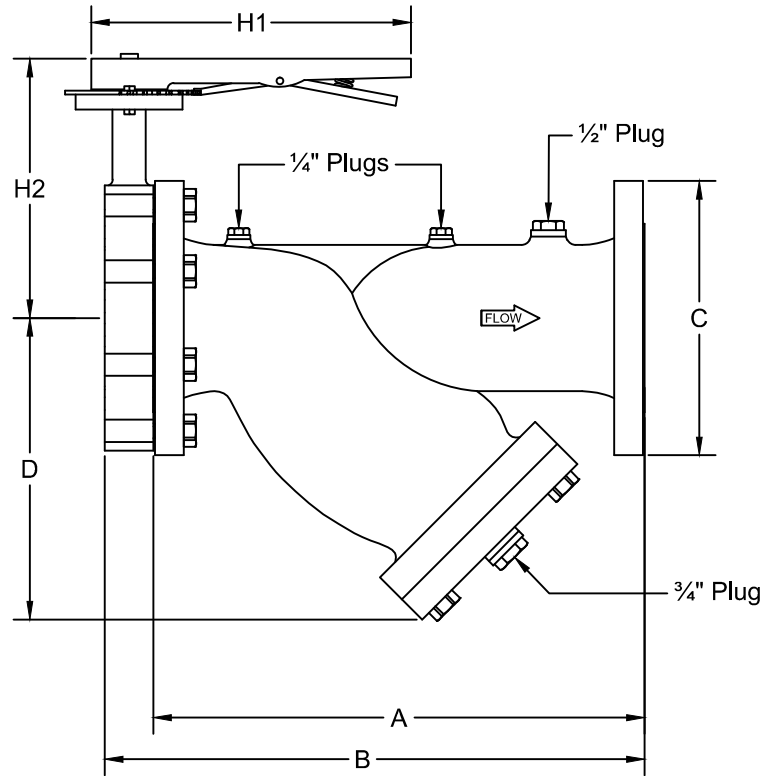

SIZE	MODEL	A	B	C	D	H1	H2	Weight	Perforations
2½"	CBYS250	11.0	12.8	7.0	7.0	10.5	8.1	33	0.055"
3"	CBYS300	12.0	13.8	8.0	7.5	10.5	8.2	43	0.055"
4"	CBYS400	14.0	16.0	9.5	9.0	10.5	9.0	69	0.115"
6"	CBYS600	18.5	20.7	13.0	11.0	10.5	10.2	163	0.115"
8"	CBYS800	21.7	24.1	15.0	13.5	*	*	203	0.115"

\* Denotes a gear operated valve.

Note: All dimensions and materials are subject to minor variations. Consult with factory for confirmation of dimensions and material specifications at the time of order.