

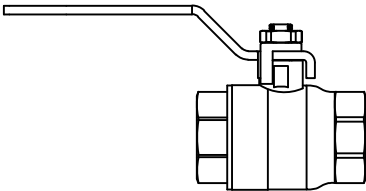
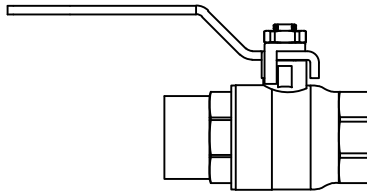

BV Series Specifications

Brass Ball Valve

FULL PORT - FPT x FPT	Size	Model #
	1/4"	BVF25FF
	1/2"	BVF1FF
	3/4"	BVF2FF
	1"	BVF3FF
	1 1/4"	BVF4FF
	1 1/2"	BVF5FF
	2"	BVF6FF
	2 1/2"	BVF7FF

FULL PORT - FPT x SWT	Size	Model #
	1/2"	BVF1FS
	3/4"	BVF2FS
	1"	BVF3FS
	1 1/4"	BVF4FS
	1 1/2"	BVF5FS
	2"	BVF6FS

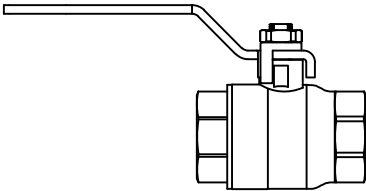
FULL PORT - FPT X FPT, w/ SS TRIM	Size	Model #
	1/2"	BVF1FFSS
	3/4"	BVF2FFSS
	1"	BVF3FFSS
	1 1/4"	BVF4FFSS
	1 1/2"	BVF5FFSS
	2"	BVF6FFSS

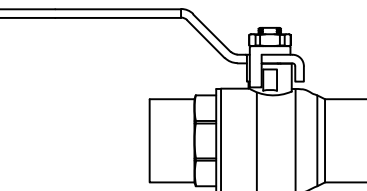
FULL PORT - SWT x SWT	Size	Model #
	1/2"	BVF1SS
	3/4"	BVF2SS
	1"	BVF3SS
	1 1/4"	BVF4SS
	1 1/2"	BVF5SS
	2"	BVF6SS

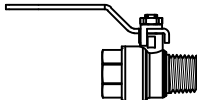
1/4" MINI BALL VALVE	Model #
	MV025 (MPT x FPT)

PRODUCT DESCRIPTION: The BV model is a two-piece brass ball valve available with a full port ball. End connections available are FPT x FPT, SWT x SWT, and FPT x SWT. All ball valves come standard with a memory stop, blow-out proof brass stem, and a double o-ring stem seal.

STANDARD OPERATING SPECIFICATIONS		STANDARD MATERIAL SPECIFICATIONS	
Working Pressure:	600 WOG / CWP	Ball Valve	Forged Brass ASTM B283-06
Working Temperature:	-22°F to 250°F	O-Ring	EPDM
Pipe Threads:	National Pipe Thread Standard (BSPP Available)	Handle	Chrome Plated Steel with Vinyl Cover
Suitable Medium:	Water, Oil, Gas	Stem	Brass ASTM B124-09 - Explosion Proof
Steam Rating:	125 PSIG Saturated Steam	Ball	Chrome Plated Brass
		Ball Seat	Teflon (PTFE)
		SS Ball	ASTM A276 Type 304
		SS Stem	ASTM A276 Type 304
Specification information is provided to assist and is given without obligation or warranty. The Company reserves the right to make changes in design, materials, and/or specifications without notice or liability.			



BV Series Dimensions

Brass Ball Valve

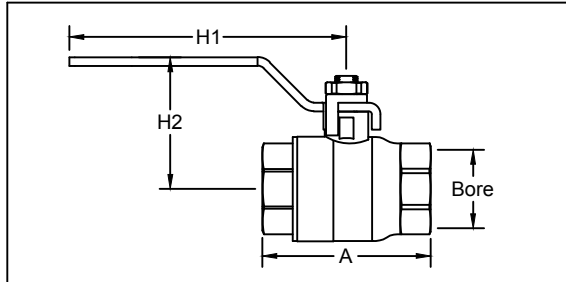

FULL PORT - FPT x FPT

Model	Size	A	Bore	H1	H2	Cv	Weight
BVF25FF	¼"	1.5	0.40	2.5	1.5	6	0.2
BVF1FF	½"	2.1	0.59	3.5	1.8	20	0.4
BVF2FF	¾"	2.4	0.79	3.5	1.8	36	0.6
BVF3FF	1"	2.8	0.98	4.6	2.8	50	1.0
BVF4FF	1¼"	3.2	1.26	4.6	2.8	104	1.3
BVF5FF	1½"	3.6	1.57	5.5	2.8	268	2.0
BVF6FF	2"	4.3	1.97	6.2	3.1	300	3.0
BVF7FF	2½"	5.5	2.56	8.5	4.2	619	7.0

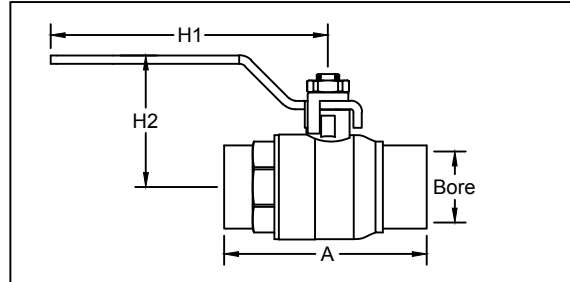

FULL PORT - SWT x SWT

Model	Size	A	Bore	H1	H2	Cv	Weight
BVF1SS	½"	3.5	0.55	3.5	1.8	22	0.5
BVF2SS	¾"	3.7	0.75	3.5	1.8	37	0.7
BVF3SS	1"	4.5	0.94	4.6	2.8	55	1.1
BVF4SS	1¼"	5.5	1.22	4.6	2.8	110	1.7
BVF5SS	1½"	5.5	1.50	5.5	2.8	273	2.3
BVF6SS	2"	5.9	1.90	6.2	3.1	308	3.5

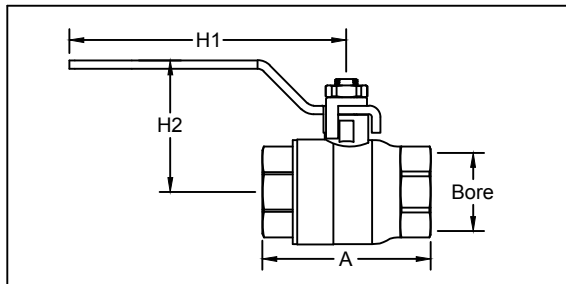

FULL PORT - FPT x FPT, SS Trim

Model	Size	A	Bore	H1	H2	Cv	Weight
BVF1FF	½"	2.4	0.59	3.5	1.8	20	0.4
BVF2FF	¾"	2.8	0.79	3.5	1.8	36	0.6
BVF3FF	1"	3.2	0.98	4.6	2.8	50	1.0
BVF4FF	1¼"	3.6	1.26	4.6	2.8	104	1.3
BVF5FF	1½"	4.3	1.57	5.5	2.8	268	2.0
BVF6FF	2"	5.5	1.97	6.2	3.1	300	3.0

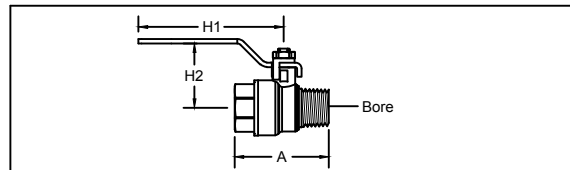

¼" MINI BALL VALVE

Model	A	Bore	H1	H2	Cv	Weight
MV025M (MPT x FPT)	1.6	0.40	2.5	1.1	6	0.17

NOTE: All dimensions, weights, and materials are subject to minor variations. Consult with factory for confirmation of dimensions, weights, and material specifications. The sweat size listed is nominal and will differ from the actual, measurable size.